

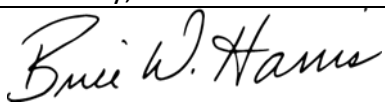

The Board of Governors of the California Community Colleges

PRESENTED TO THE BOARD OF GOVERNORS
DATE: March 21-22, 2016

SUBJECT: Relocation and Name Change of Middlefield Education Center, Foothill–De Anza Community College District		Item Number: 1.2	
		Attachment: No	
CATEGORY:	College Finance and Facilities Planning	TYPE OF BOARD CONSIDERATION:	
Recommended By:	 Dan Troy, Vice Chancellor	Consent/Routine	X
		First Reading	
Approved for Consideration:	 Brice W. Harris, Chancellor	Action	
		Information	

ISSUE: This item seeks approval for the Foothill–De Anza Community College District to relocate the existing programs at Foothill College’s Middlefield Center to a new location to be called the Foothill College Education Center. The current “grandparented” center status for the Middlefield Center will transfer to the new site, which is anticipated to serve approximately 1,300 to 1,600 full-time equivalent students (FTES) annually. The district currently receives \$1.1 million in apportionment funds for the site and that will remain the same at the new site. In 2013-14, the Middlefield Center served 1,499 FTES. The California Code of Regulations, title 5, section 55180(b)(2) defines a “grandparented center” as a center that was identified by the Chancellor’s Office as of the 2006-07 fiscal year which:

- Operated prior to April 1974 and recognized as an approved grandfathered center by the California Postsecondary Education Commission (CPEC) in a December 1984 report;
- Served at least 100 FTES as reported on the final attendance report for fiscal year 2005-06 or had an average annual FTES for the three prior fiscal years (2003-04 to 2005-06) of at least 100 FTES;
- Operated continuously since 1974;
- Was owned or controlled by the district through a lease agreement; and
- Provided an appropriate level of administrative and student services, relative to its size.

RECOMMENDATION: Approve the relocation and name change of the Foothill College Middlefield Center to the new proposed Foothill College Education Center site; the approval will include the transfer of the current “grandparented” center status to the new site.

BACKGROUND: The Foothill–De Anza Community College District has two colleges (Foothill College, and De Anza College) and one “grandparented” center (Middlefield Center). Since 1984, the Middlefield Center has been located in a long-term lease facility built in 1955 by the Palo Alto Unified School District as a high school. The facility is still owned by the Palo Alto Unified School District with a master lease held by the City of Palo Alto. The Palo Alto Unified School District has no interest in selling the property and intends to repurpose the facility when the Middlefield Center is vacated.

The existing Middlefield Center operations and academic program will be transferred to the new Foothill College Education Center facility at the 1070 Innovation Way site in Sunnyvale, California. The new facility will allow for the expansion of the center’s academic programs, stressing workforce development to take advantage of the new location in an expanding center of high technology. Existing Business, Computer Science, Child Development, Emergency Medical Services, English, ESL, Mathematics, and Music programs and courses will be transferred from the old center site to the new Foothill College Education Center facility. Local student population and businesses represented by the campus advisory committee have identified Computer Science, GIS, and additional Business classes for transfer should be added to the curriculum. The new facility will allow these community needs to be further addressed.

The comprehensive in-person student services currently being provided at the Middlefield Center will also transfer to the new Foothill College Education Center. The services include enrollment services, financial aid, bookstore, basic health services, student activities, general counseling, veteran’s services, counseling for students with disabilities, placement testing, accommodated testing, tutoring and outreach.

The new Foothill College Education Center site is approximately 4 miles southeast of the Middlefield Center site. The new Foothill College Education Center site is located in an area known as the Moffett Business Park in the northern part of the City of Sunnyvale. The city is actively promoting the business park as a center for high technology tenants. Current occupants include Google, Juniper Networks and Yahoo. The business park is located at the confluence of major freeways and transit hubs. The site is located immediately adjacent to the intersection of Highway 101 and Highway 237 with easy freeway access. Two light rail stops bracket the site, each a safe and easy walk to the center. Several Valley Transit Authority bus routes also serve the business park.

The 100% district funded Foothill College Education Center facility will be a 47,100 gross square foot, two-story building with paved on-grade parking supplemented by a gravel finished parking lot to accommodate overflow parking. The new facility will contain 38,000 assignable square feet (asf) consisting of 8,600 asf of lecture space, 13,100 asf of laboratory space, 5,010 asf of office space, 830 asf of library space, and 10,460 asf of other instruction support and service space. The 9.15 acre parcel is master planned to allow construction of a second building and development of additional parking spaces in the future. The new Foothill College Education Center facility is scheduled to be completed by the fall quarter of 2016.

The district will be submitting an Initial Project Proposal (IPP) for partial state funding of Phase II construction of the Foothill College Education Center. The IPP requests a start of design in fiscal year 2019-20, with occupancy scheduled for fiscal year 2022-23. The IPP proposes to construct a new 24,519 assignable square foot (asf) facility containing 1,630 asf of lecture space, 18,889 asf of laboratory space, and 4,000 asf of office space.

Map showing the locations of the existing Middlefield Center site and the new Foothill College Education Center site

Point A to B = County Line

Point B to C = Sunnyvale City Limit

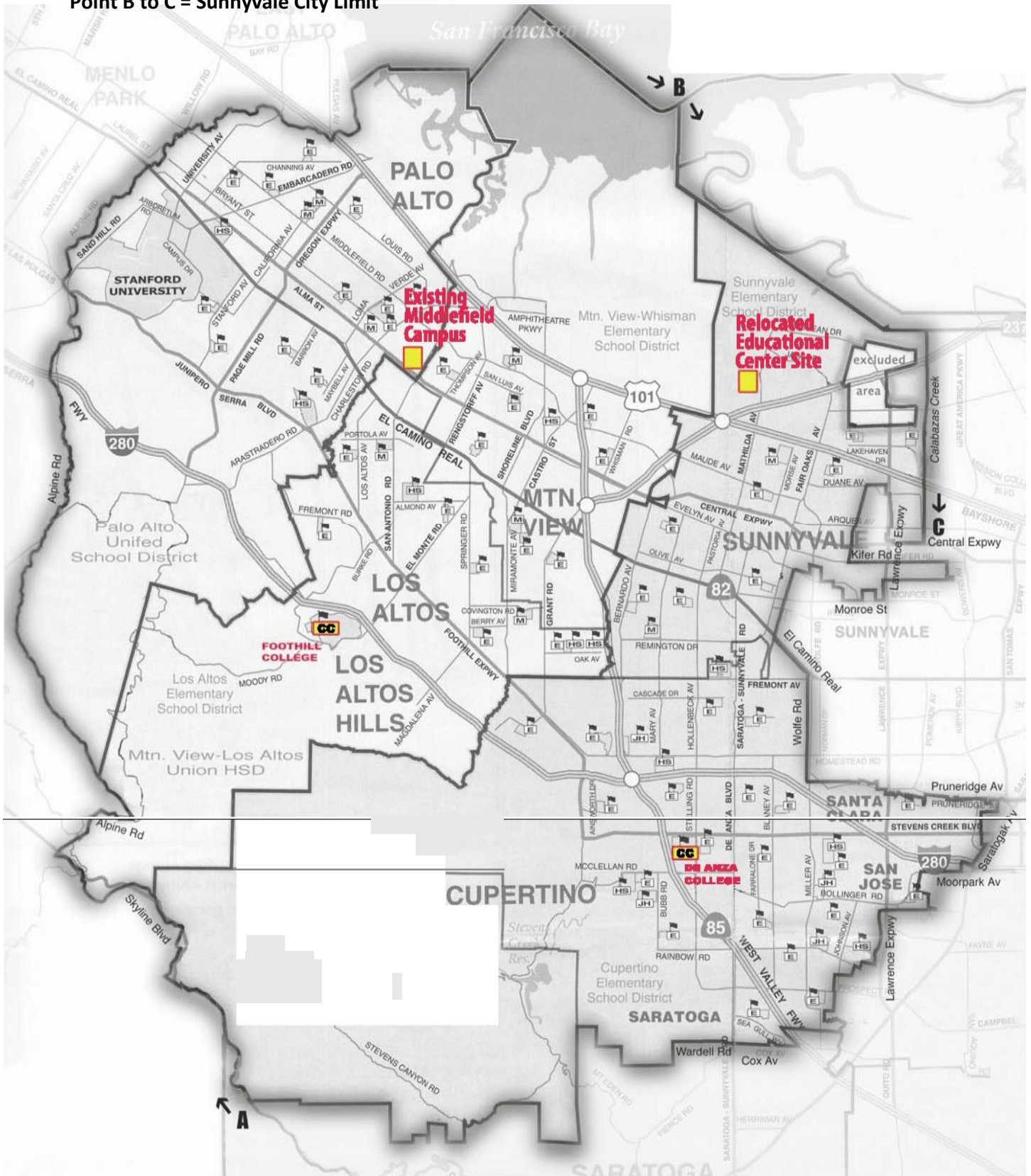

Site Plan for the proposed new Foothill College Education Center:

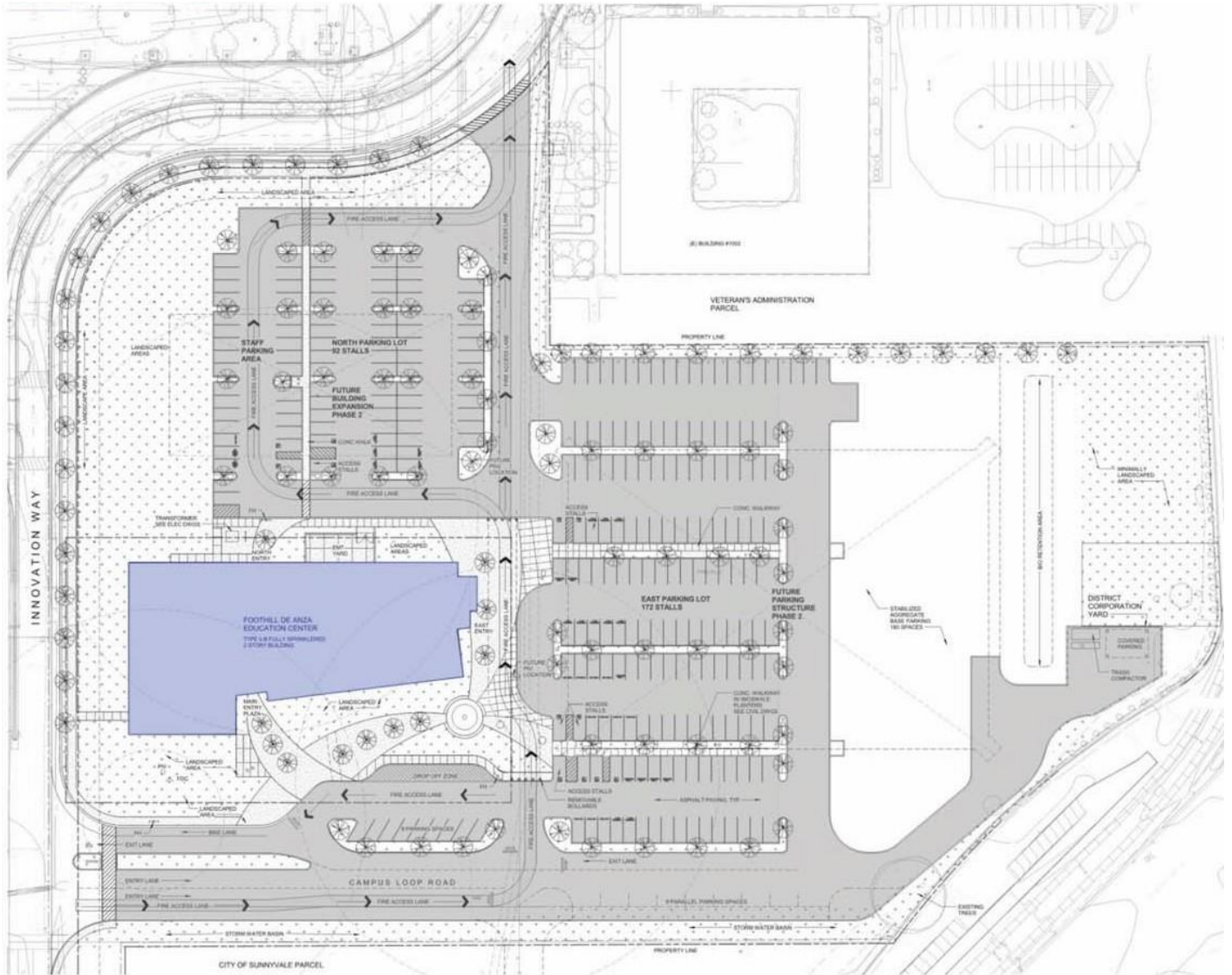

Staff: Eric Thorson, Specialist
College Finance and Facilities Planning